

A3

26/01/2024 08:19

- Legend**
- Order Limits
  - Areas of Archaeology Identified During Trenching
- Panel Areas**
- Panel Area A: Brafferton
  - Panel Area B: Around Hauxley Farm
  - Panel Area C: Around Byer's Gill Wood
  - Panel Area D: Great Stainton
  - Panel Area E: West of Bishton
  - Panel Area F: North of Bishton
- Geophysical Interpretation**
- Possible archaeology

Coordinate System: British National Grid  
 Contains Ordnance Survey data © Crown Copyright and database right 2023.

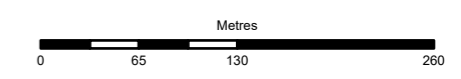

P01.01	26/01/24	OD	--	--	--
Rev	Date	By	Chkd	Appd	Authd

Client



Project Name  
**Byers Gill Solar**

Drawing Title  
**FINAL**

Scale at A3  
**1:5,000**

Role  
**INITIAL STATUS OR WIP**

Suitability  
**S0**

Project Number  
**286386-00**

Rev  
**P01.01**

Drawing Number  
**BGS-SR-00004**

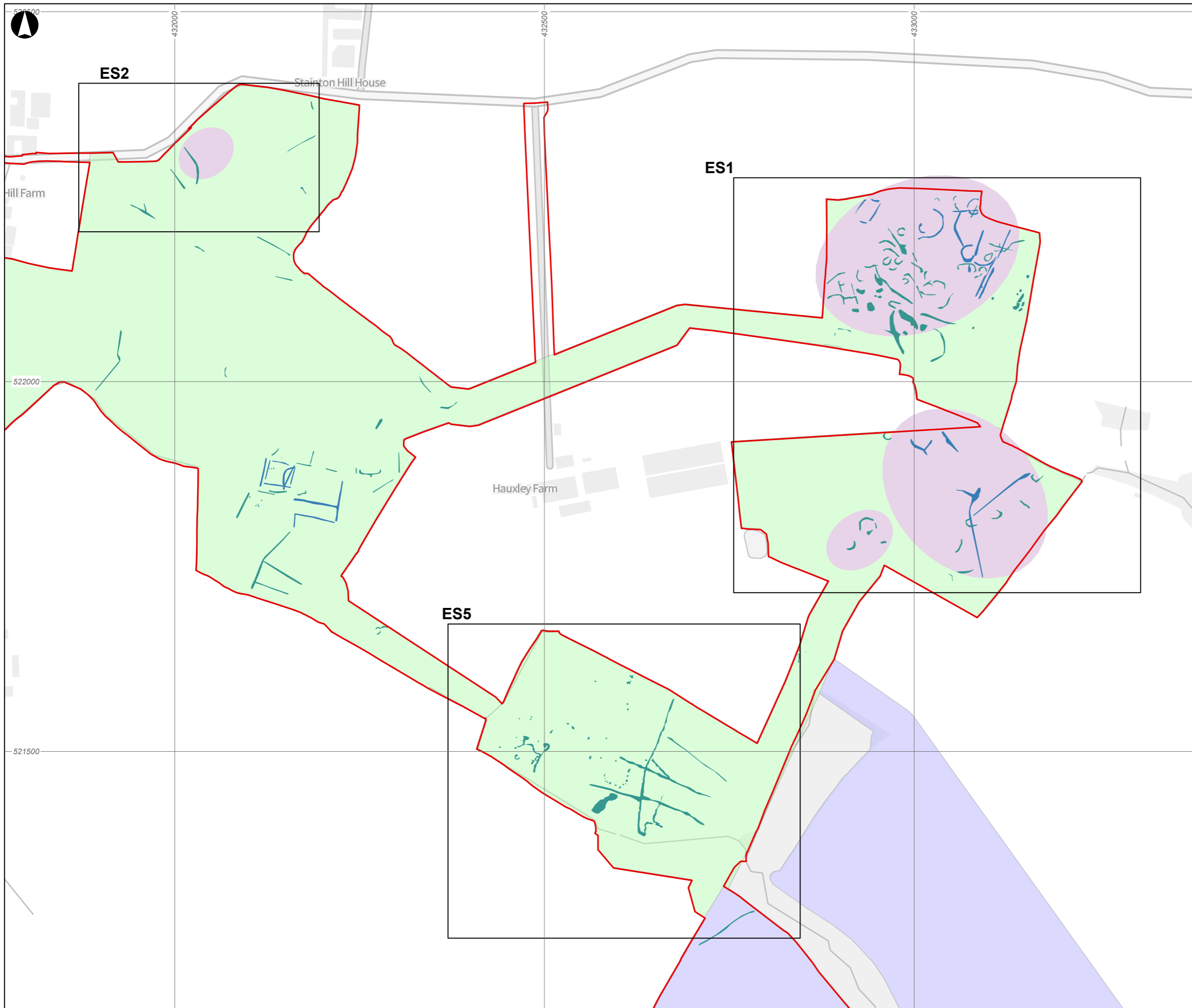

- Legend**
- Order Limits
  - Areas of Archaeology Identified During Trenching
- Panel Areas**
- Panel Area A: Brafferton
  - Panel Area B: Around Hauxley Farm
  - Panel Area C: Around Byer's Gill Wood
  - Panel Area D: Great Stainton
  - Panel Area E: West of Bishopton
  - Panel Area F: North of Bishopton
- Geophysical Interpretation**
- Archaeology
  - Possible archaeology

Coordinate System: British National Grid  
 Contains Ordnance Survey data © Crown Copyright and database right 2023.

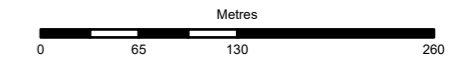

P01.01	26/01/24	OD	--	--	--
Rev	Date	By	Chkd	Appd	Authd

Client



Project Name  
**Byers Gill Solar**

Drawing Title  
**FINAL**

Scale at A3  
**1:5,000**

Role  
**INITIAL STATUS OR WIP**

Suitability  
**S0**

Project Number  
**286386-00**

Rev  
**P01.01**

Drawing Number  
**BGS-SR-00004**

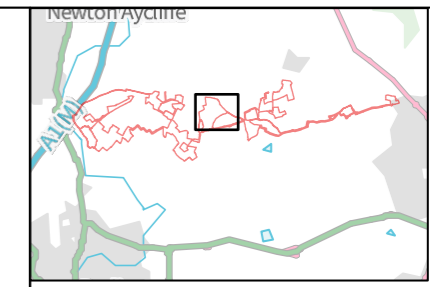
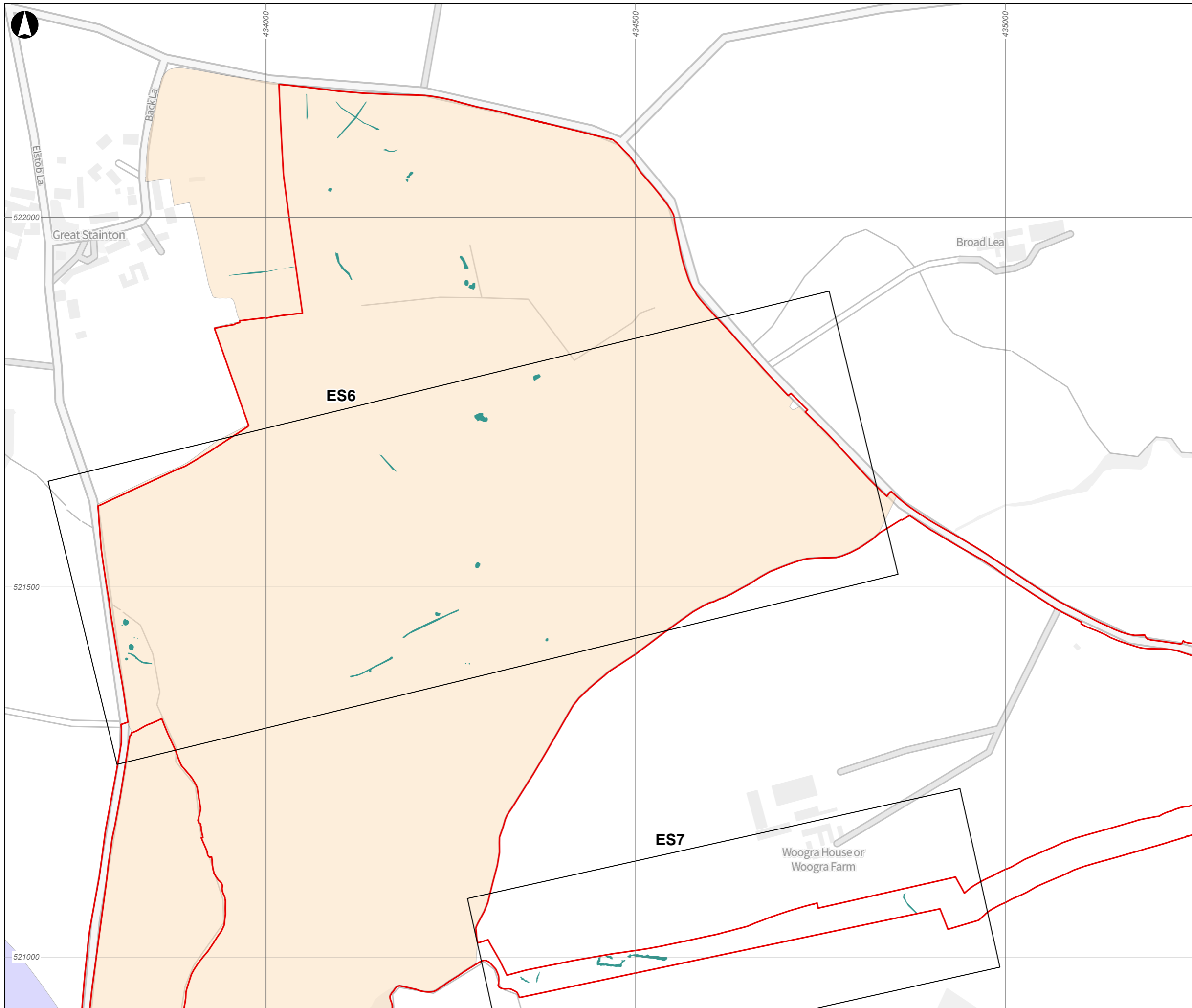

A3

26/01/2024 08:20

- Legend**
- Order Limits
  - Areas of Archaeology Identified During Trenching
- Panel Areas**
- Panel Area A: Brafferton
  - Panel Area B: Around Hauxley Farm
  - Panel Area C: Around Byer's Gill Wood
  - Panel Area D: Great Stainton
  - Panel Area E: West of Bishopton
  - Panel Area F: North of Bishopton
- Geophysical Interpretation**
- Possible archaeology

Coordinate System: British National Grid  
 Contains Ordnance Survey data © Crown Copyright and database right 2023.

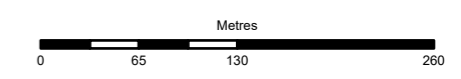

P01.01	26/01/24	OD	--	--	--
Rev	Date	By	Chkd	Appd	Authd

Client



Project Name  
**Byers Gill Solar**

Drawing Title  
**FINAL**

Scale at A3  
**1:5,000**

Role  
**INITIAL STATUS OR WIP**

Suitability  
**S0**

Project Number  
**286386-00**

Rev  
**P01.01**

Drawing Number  
**BGS-SR-00004**

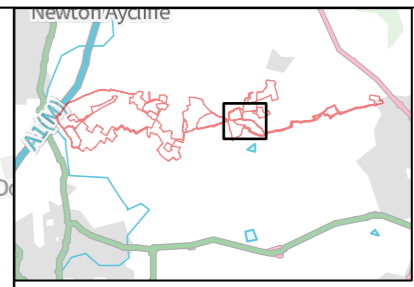
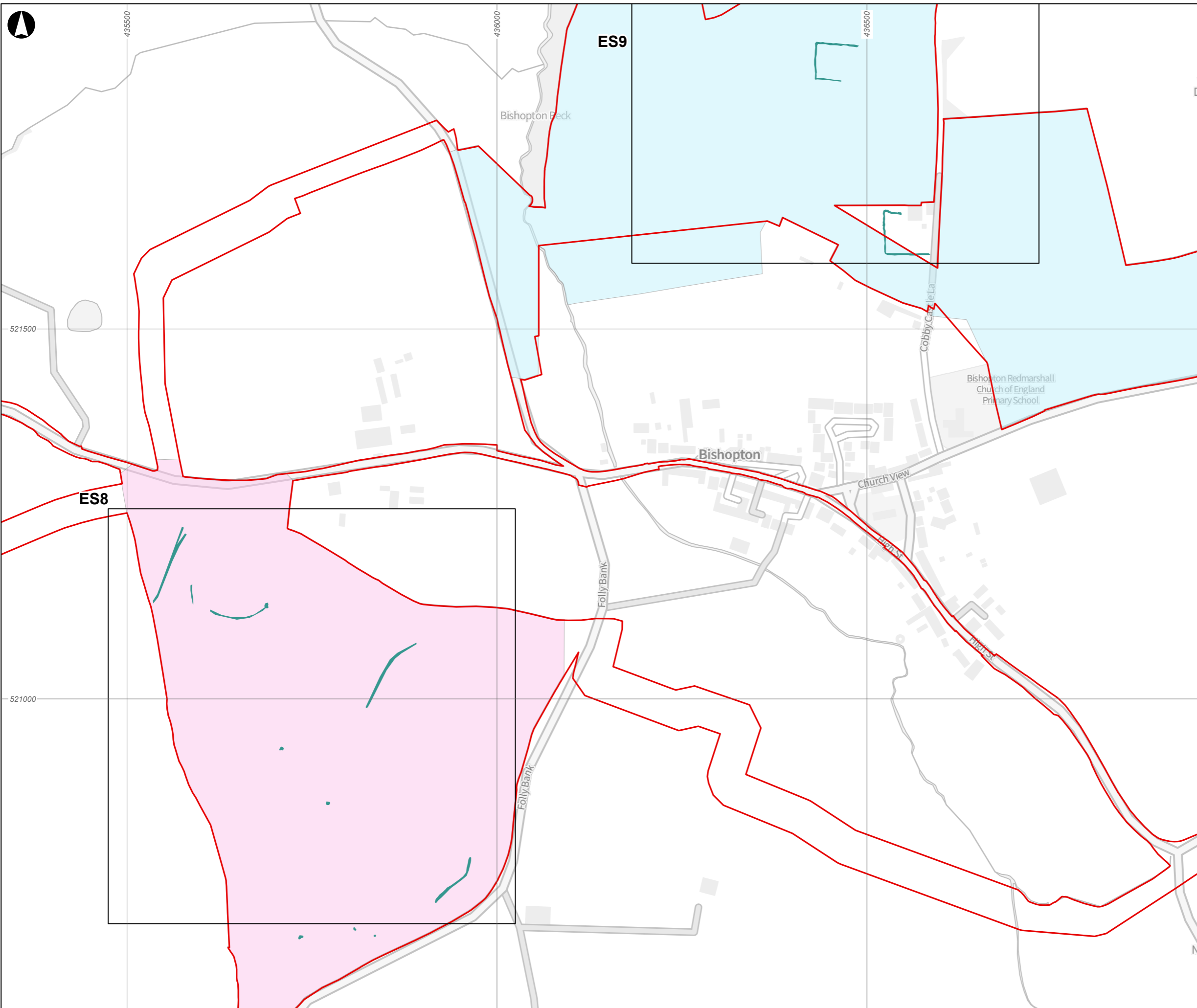

A3

26/01/2024 08:20

**Legend**

- Order Limits
- Areas of Archaeology Identified During Trenching
- Panel Areas**
- Panel Area A: Brafferton
- Panel Area B: Around Hauxley Farm
- Panel Area C: Around Byer's Gill Wood
- Panel Area D: Great Stainton
- Panel Area E: West of Bischopton
- Panel Area F: North of Bischopton
- Geophysical Interpretation**
- Possible archaeology

Coordinate System: British National Grid

Contains Ordnance Survey data © Crown Copyright and database right 2023.

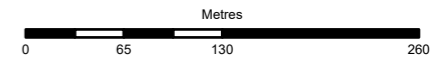

P01.01	26/01/24	OD	--	--	--
--------	----------	----	----	----	----

Rev	Date	By	Chkd	Appd	Authd

Client



Project Name  
**Byers Gill Solar**

Drawing Title  
**FINAL**

Scale at A3  
**1:5,000**

Role  
**INITIAL STATUS OR WIP**

Suitability  
**S0**

Project Number  
**286386-00**

Rev  
**P01.01**

Drawing Number  
**BGS-SR-00004**